

# THINKWARE DASH CAM™ F750



CES 2015  
Award Winner



World's First Design Award Grand Slam

## Features



### Safety Camera Alert

The built-in GPS antenna tracks the road and direction of travel to notify the driver of photo enforced areas for safe driving



### Road Safety Warning System

- FCWS (Forward Collision Warning System)
- LDWS (Lane Departure Warning System)



### 2 Channel Full HD (Optional)

With the 1920X1080P Full HD front / rear camera, you can accurately record movement of any object, approaching the camera.



### DUAL SAVE™

The Dual Save Technology guarantees a backup copy of videos in the internal memory after any incident



### Built-In Wi-Fi

Mobile app enables Live View streaming and allows users to save videos to their smartphones via Wi-Fi connection



### Mobile Application

Intuitive and easy-to-use iOS / Android mobile application provides instant video playback as well as controls various device settings



### Sony Exmor Image Sensor

219M Sony Exmor image sensor can greatly improve the quality of both day time and night time images.



### Thermal Self-Protection

The thermal sensor triggers the self-protection mechanism to shut down the device under extreme temperatures



### Fail-Safe Technology

Using Super Capacitor Technology, recordings are safely archived in case of sudden power shut-off due to an accident



### GPS Antenna

Internal built-in GPS antenna embeds speed and location data to the video which can be displayed on the PC viewer

# Specification Detail

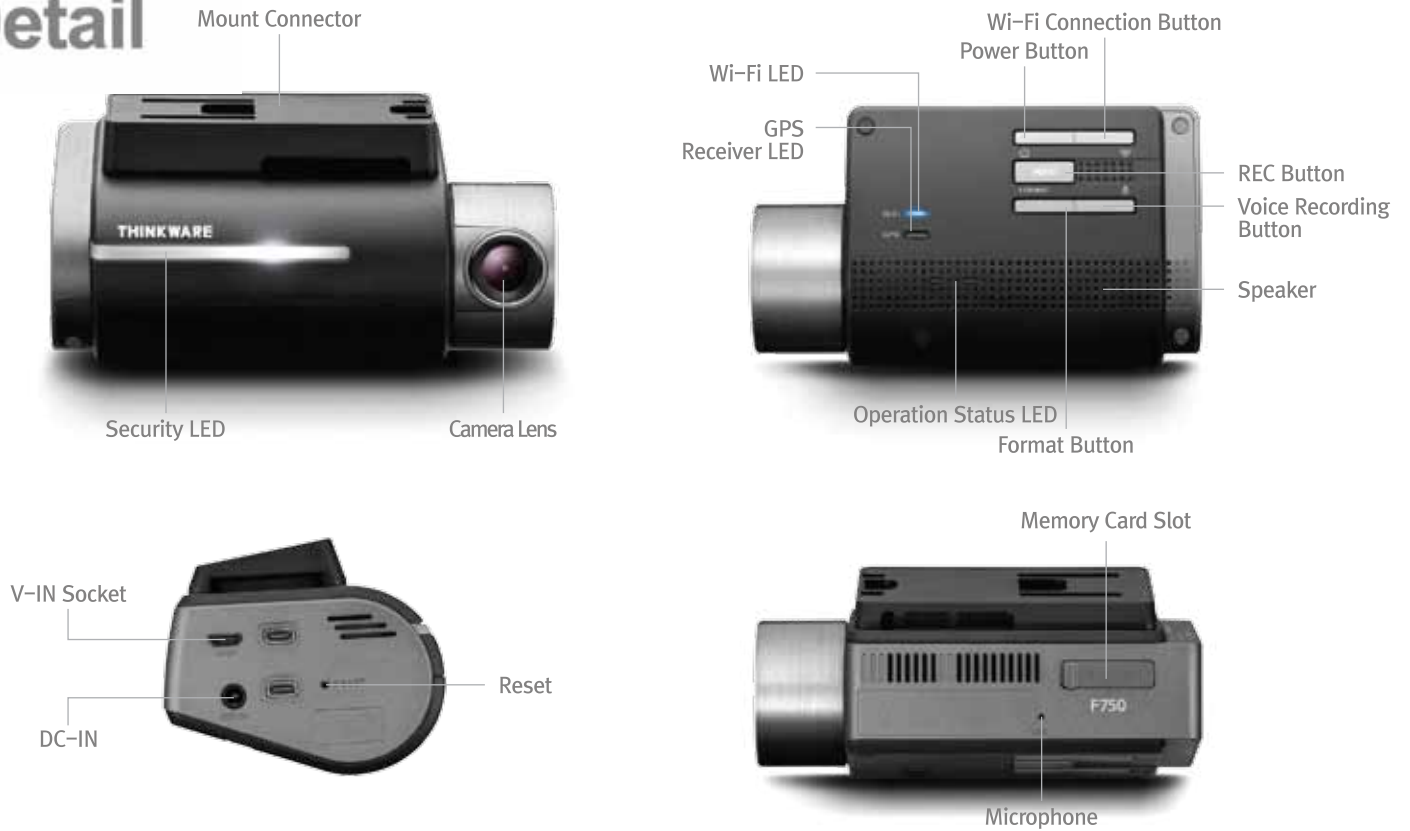

## Technical Specification

- **Resolution :** F - Full HD (1920x1080P)  
R - Full HD (1920x1080P)
- **Camera (Image sensor) :**  
F - Sony Exmor CMOS 2.19MP  
R - Sony Exmor CMOS 2.19MP(optional)
- **Frame rate :** 2Ch, 30 fps
- **Viewing Angle :** 140° (Diagonal)
- **Dimensions (WxDxH) :** 105.2 x 61.5 x 41mm
- **Weight :** 140.5g (0.31 lbs)
- **GPS :** Built in GPS (Glonass supported)
- **Wireless Connectivity :** Built-In Wi-Fi
- **Storage Temperature :** -20° ~ 70° C
- **Operating Temperature:** -10° ~ 60° C
- **Capacity :** Micro SD card 16G, 32G, 64G UHS-1
- **Interface :** AV-In port 1EA  
DC-In / Micro SD Slot
- **Input Power :** DC 12/24V  
Built-in Super Capacitor

## Recording time

Video Quality		Full HD 30fps	Full HD + Full HD 30fps
Capacity	16 GB	124 min	62 min
	32 GB	248 min	124 min
	64 GB	496 min	248 min

## What's In the Box

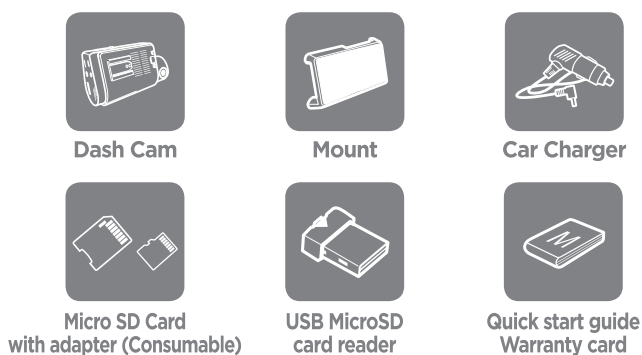

## Optional Accessories

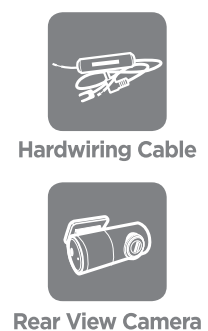

**THINKWARE**